

ZE-800

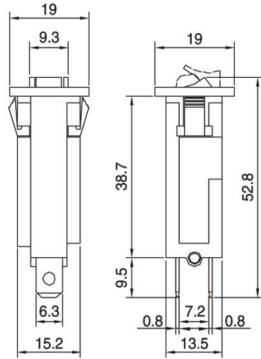

Dimension in mm

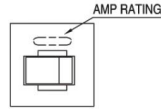

Recommended panel cutouts

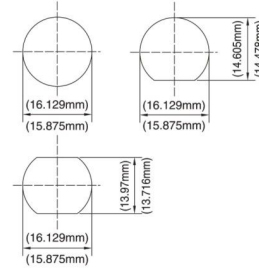

Approval

- * Approval: 2-18 A 125/250 VAC
- * Approval: 3-15 A 125 VAC
- * Approval: 2-15 A 125/250 VAC

Specifications

- *Standard Rating: 1.5-20 AMPER.
- *Input Power: 125 VAC/250 VAC/32 VDC.
- *Dielectric Strength: 1500 VAC / 1 Minute.
- *Interrupt Capacity: 125 VAC×1000 A, 250 VAC×200 A.
- *Insulation Resistance: > 100 MΩ
- *Calibration: 25°C-105°C of Rated Current-Continuously Carried.
 - 25°C-Between 101% to 134%-May Trip or Not.
 - 25°C-135% of Rated Current-Trip Within 1 Hour.
 - 25°C-200% of Rated Current-Trip Within 1 Minute.
- *Contact Endurance:
 - 125 VAC×150% of Rated Current-500 Cycles.
- *Reset: Manual Push Reset/Auto Reset.

Trip Time Curve

Interrupting characteristics @+25°C

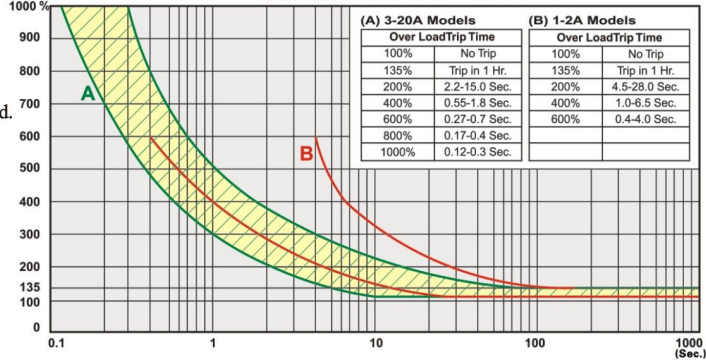

	MAX. Internal Resistance
1.5A-2A	0.150 Ω
2.5A-3A	0.120 Ω
3A-4A	0.080 Ω
4A-5A	0.040 Ω
5A-6A	0.025 Ω
6A-7A	0.020 Ω
8A-9A	0.016 Ω
10A-11A	0.012 Ω
12A-13A	0.010 Ω
14A-16A	0.008 Ω
18A-20A	0.006 Ω